

User's Manual

Tools:

- Spray, sponge or cloth for the application of soapy solution to the door;
- Plastic or rubber spatula (or use anything else handy which does not scratch the surface, such as a credit card or a driving licence) for smoothing the surface of the sticker;
- Mild soapy solution (Fairy, baby shampoo or any other mild foamy substance without additives);
- Sharp knife or a razor for trimming the edges;
- Scissors for cutting the sticker to size, measuring tape, pencil;

1) Preparing the Door

- If possible, remove the handles;
- Remove all stickers and any residual glue (with a solvent, if necessary);
- Clean the surface of all dirt;
- Measure the height of the surface you wish to cover. If there is more than one door, the doors will have to be measured separately;
- Use the pencil to mark the centre of upper and lower edge of the fridge door.

2) Preparing the Sticker

- Cut the sticker to a right size, leaving a spare inch on top and bottom. If you have more than one door, cut a separate sticker for each door, allowing for extra inch both top and bottom;
- Mark central points of the sticker.

NB! Edges will be trimmed after the placement

3) Placement

- a) Apply the soapy solution to the door, using a spray or a sponge (Fig. 1)

NB! Do not wet sides of the door

- b) Carefully remove the paper from the back of the sticker;
- c) Place the sticker to the door, check for alignment of marked central points on the door and the sticker;
- d) Check for good placement of the sticker. If the sticker is misaligned, remove the sticker and fit it again;
- e) Using gentle pressure of spatula remove the water under the sticker using the direction from the centre towards the edges. (Fig. 2)
- NB! Check for bubbles of air or water under the sticker. Dry excess water.

- f) If your fridge has mouldings, press the sticker carefully on the mouldings.

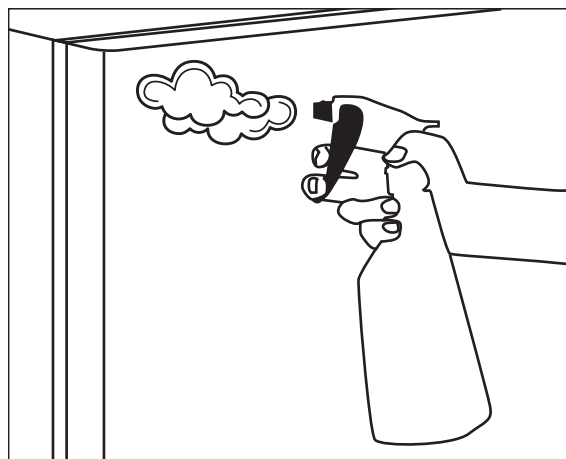

figure 1

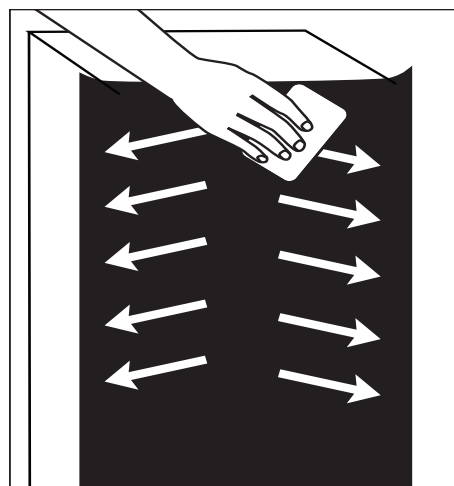

figure 2

g) Press the remaining sticker against the sides of the door and trim the sticker with a sharp knife or a razor. Take care not to pierce the insulating seal. For maximum cutting precision hold the knife under 90 degree angle in relation to the door, keep the sticker taut with the other hand (Fig. 3);

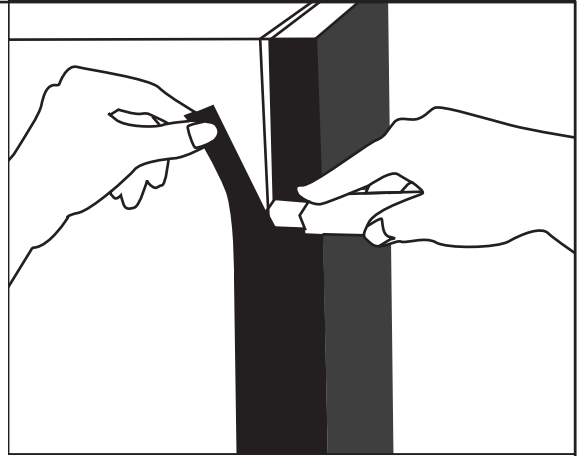

figure 3

h) Cut off extra material along the moulding edge (Fig. 4)

If it is not possible to remove the handles of the fridge, measure the sticker for handle location and cut a hole in the sticker (smaller than the handle). Without removing the paper at the back of the sticker, check for the right location. Place as described above, cut to size.

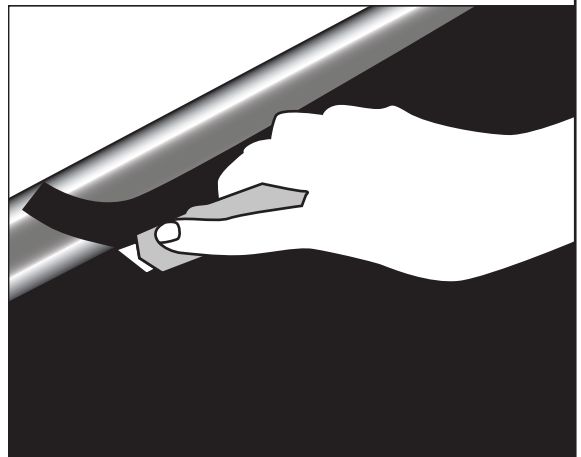

figure 4

4) Finishing

- a) Use a sharp object to pierce the sticker to create holes for handle screws. Reinstall handles.
- b) If any bubbles have remained under the stickers, it is possible to pierce the bubble with a needle and remove the water by pushing towards the needle-hole from both sides.

*Invite your family and friends, step back and admire your work and new kitchen.
Design stickers can also be applied elsewhere.*

If you are not sure you can install the design sticker properly, use of professional help is recommended.